

Chassis Mount Kits - Installation Details

Thank you for purchasing your Aquavision.

Installation is very simple and we recommend it happens as follows

1. Make sure that you have cut a hole in the wall to the correct size and have got 2 wooden uprights, one either side, to fix into. You can fix straight into masonry but wood is the preferred option for ease of fixing

2. Insert the correct number of fixings for each model into the uprights at the correct spacing, leaving approx. 12mm or ½" of screw protruding to clip the tailored collection chassis onto



3. Attach the LCD to the back of the chassis with the white plastic thumb nuts provided.
4. Connect all cables and test.
5. Offer the mirror assembly onto the wall and it will locate onto the screws and drop around 5mm or ¼" to its resting place
6. If this is to be used in a wet area, you will need to apply a bead of silicone around the side, between the glass and the wall to prevent water ingress

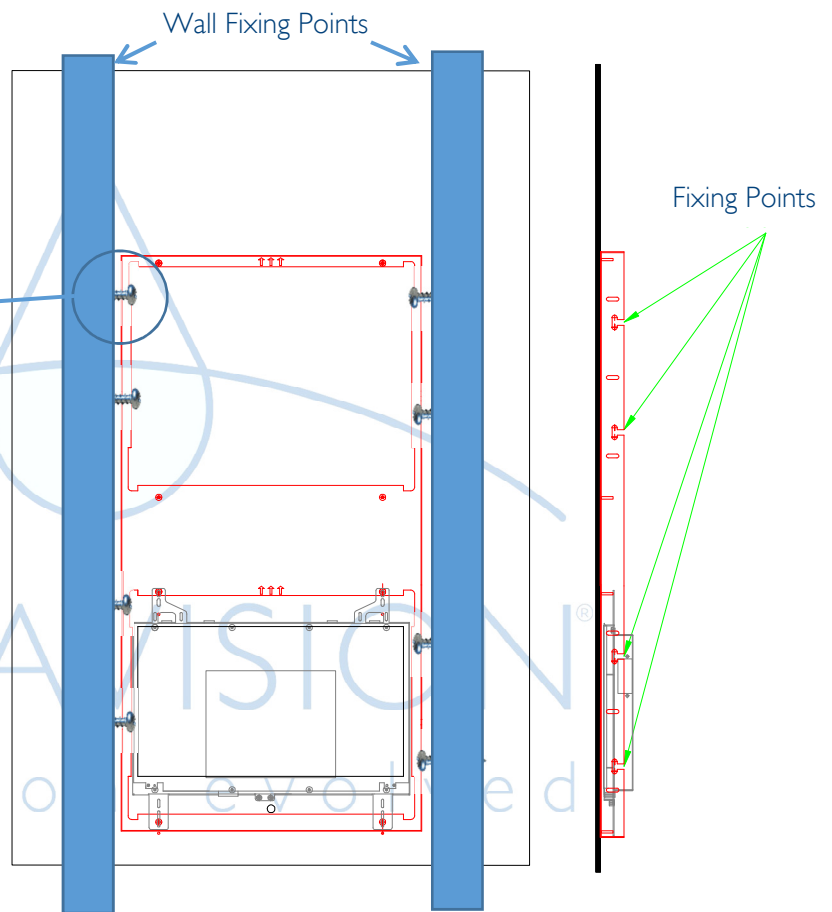

Sizes and style may vary from that shown, but fixing method will be the same.



HEAD OFFICE AND FACTORY
Aquavision
Unit 2 Grosvenor Business Park
Horsfield Way, Stockport
Cheshire, SK6 2SU
United Kingdom
+44 [0]161 711 900

AMERICAN OFFICE
Aquavision, Inc.
#197
5 Southside Drive, Suite 11
Clifton Park, NY 12065
America
+1 800 524 1804



sales@aquavision.tv
sales@aquavision.us

www.aquavision.tv
www.aquavision.us