

# Bespoke Glass Bezel & LCD Guide

Installing your Aquavision bespoke couldn't be easier. Your glass should have been supplied with the metal screen mount bezel attached. This also has 3 fixings down each side of it spaced 140mm apart from the centre line as shown above. You will need to have a good wall or strong stud to the left and right of the bezel to support it. You will then need to provide 6 fixings, 3 either side, at 140 cms and 18mm in from the back of the glass. Fixings can be normal screws tightened into Rawlplugs or similar but leaving around 3-5mm of thread showing for the bezel to drop onto. When working out the height of these fixings remember that the glass will drop by 7-8mm dependent on the fixing size. Once this is done, it would be a good idea to check that the glass fits before you mount the LCD Screen to the bezel. Once you have confirmed that the fixings are in the right place, lay the glass down on its front and screw the LCD screen on to it carefully making sure you don't over tighten the screws causing them to damage the glass.

Connect the TV to the various power and input connections and then drop onto the brackets that you fitted earlier. It would be a good idea to power the system up and check all connections etc. **Once you are happy all is working, run a bead of silicone around all sides of the glass ensuring a watertight fit.** Remember, If any connections come out, or the screen develops a fault, you will need to remove this silicone so bear this in mind when you are applying it!

If your glass is larger than the bezel by 1meter in any direction, we advise that secondary fixing kits are used. One of these is recommended for each meter the glass is, in any direction, bigger than the bezel. These are as shown on the left and should be fixed to a strong stud or wall, and on a similar position on the back of the glass. Details of these brackets are as shown.

Screen size in inches.	Chassis Drawing Ref.	Chassis mount size. Width Height	LCD Width Height Depth	Viewing window size. Width Height	Bezel Depth	Total Depth
16"	1116-119	488 x 350	433 x 258 x 45	344 x 193	30	50
22"	1122-119	545 x 362	500 x 320 x 45	476 x 267	30	50
27"	1127-119	692 x 462	632 x 400 x 45	598 x 336.5	30	50
32"	1103-119	785 x 537	763 x 453 x 55	698 x 392	30	60
43"	1102-119	1000 x 650	955 x 555 x 55	941 x 529	30	60
55"	1155-119	1374 x 847	1236 x 709	1210 x 680	30	60
65"	1165-119	1483 x 960	1450 x 828	1428 x 803	30	60
85"	1185-119	1980 x 1205	1902 x 1083	1872 x 1053	60	100

Part 1- fixed to stud

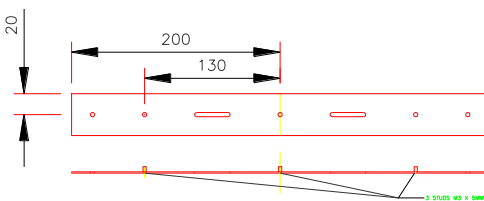

Part 2 – fixed to glass

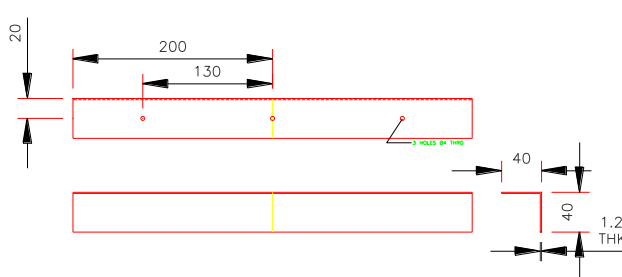

Assembled

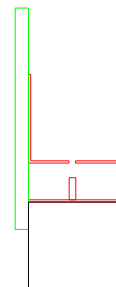

**HEAD OFFICE AND FACTORY**  
 Aquavision  
 Unit 2 Grosvenor Business Park,  
 Horsfield Way, Stockport, Cheshire  
 SK6 2SU  
 United Kingdom  
 +44 [0]161 711 1900



sales@aquavision.tv  
 sales@aquavision.us

www.aquavision.tv  
 www.aquavision.us