

# Using the Aquavision relay to switch speaker sources

To use a single speaker for your Aquavision and a second sound source such as Aquavision Echo, Sonos etc, we suggest you use our AVF-5RLYF4P, 4 pole relay switch unit. These are independent units for each Left and Right speakers. Shown below is how to set up one unit. Simply link the second unit on as shown for the second speaker.

When you turn the Aquavision on, the sound will automatically switch from the current (Echo, Sonos etc.) source, to the Aquavision Television

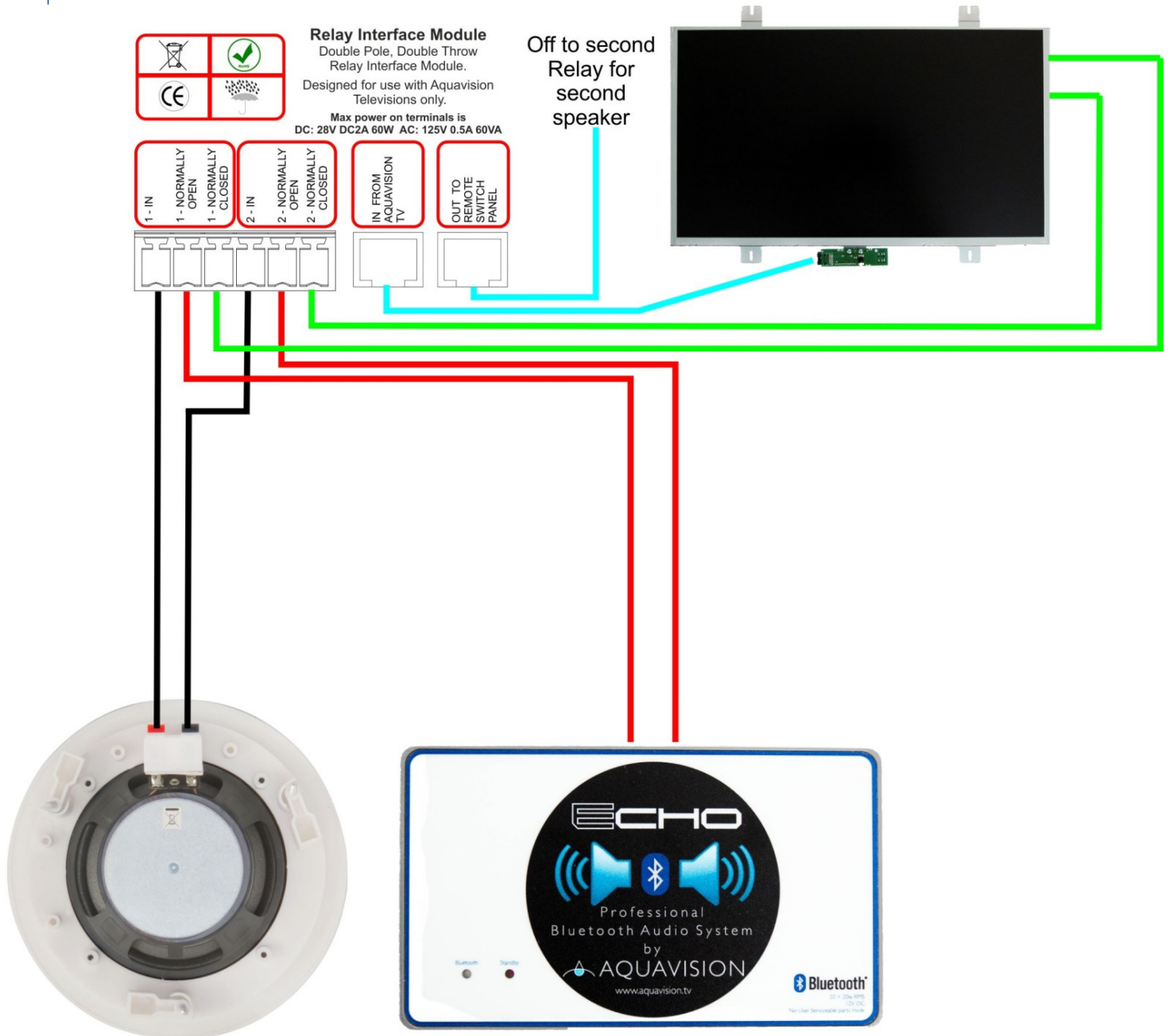

**HEAD OFFICE AND FACTORY**  
Aquavision  
Unit 2 Grosvenor Business Park  
Horsfield Way, Stockport  
Cheshire, SK6 2SU  
United Kingdom  
+44 [0]161 711 900

**AMERICAN OFFICE**  
Aquavision, Inc.  
#197  
5 Southside Drive, Suite 11  
Clifton Park, NY 12065  
America  
+1 800 524 1804

sales@aquavision.tv  
sales@aquavision.us

www.aquavision.tv  
www.aquavision.us